

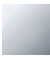



36 200 705

- inverseur rotatif
- rosace 60 x 60 mm

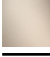

|   |                             |               |
|---|-----------------------------|---------------|
|  | Chrome                      | 36 200 705-00 |
|  | Platine brossé              | 36 200 705-06 |
|  | Dark Chrome                 | 36 200 705-19 |
|  | Champagne brossé (Or 22cts) | 36 200 705-46 |
|  | Champagne (Or 22cts)        | 36 200 705-47 |
|  | Dark Platinum brossé        | 36 200 705-99 |

### Accessoires requis



- Inverseur à 2 voies à encastrer - 35 202 970 90**
- profondeur de montage max. 160 mm
  - profondeur de montage mini. 115 mm

36 200 705

mm [inches]

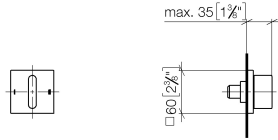

### Diagramme de débit



### Certificats

LGA\_38379.

WRAS\_2307045.

36 200 705

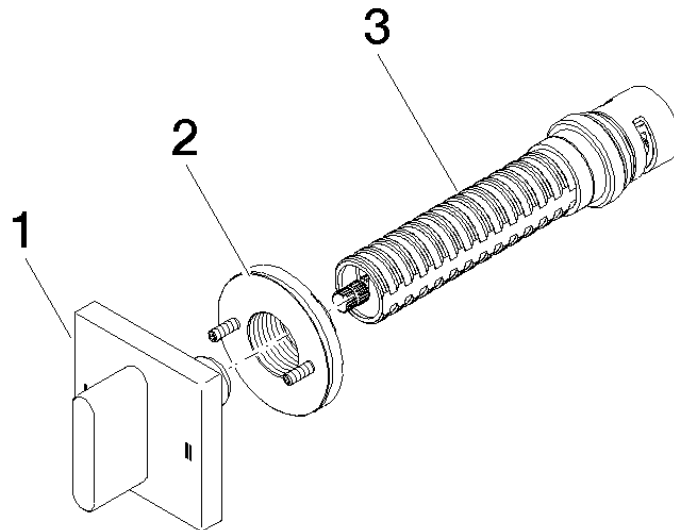

### Liste des pièces de rechange

| N° | Article Numéro     | Désignation | Fréquence de montage | Délai de livraison |
|----|--------------------|-------------|----------------------|--------------------|
| 1  | 90 20 70 051 08-00 | poignée     | 1                    | 10                 |
| 2  | 90 21 02 181 00 90 | rondelle    | 1                    | 2                  |
| 3  | 90 90 03 304 10 90 | inverseur   | 1                    | 2                  |